

Pagination

Page 1 should have no page number. Numbering should begin on Page 2, like this:

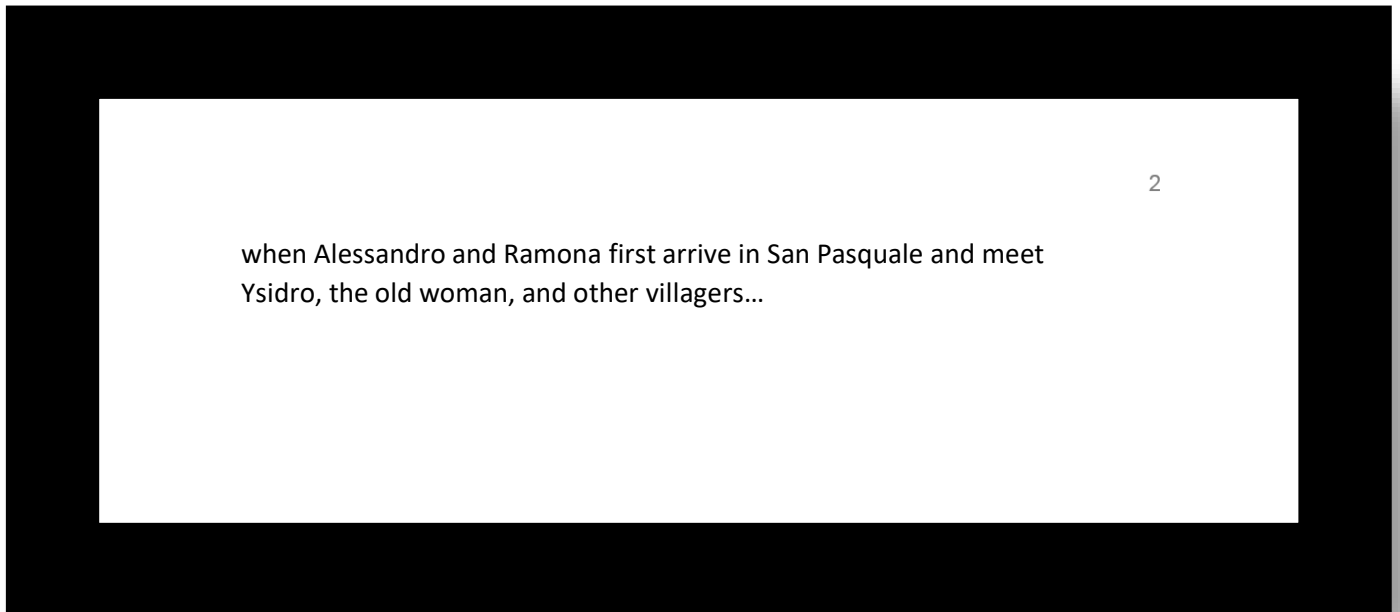

Here's the procedure in Google Docs. It's very similar in Microsoft Word and other software.

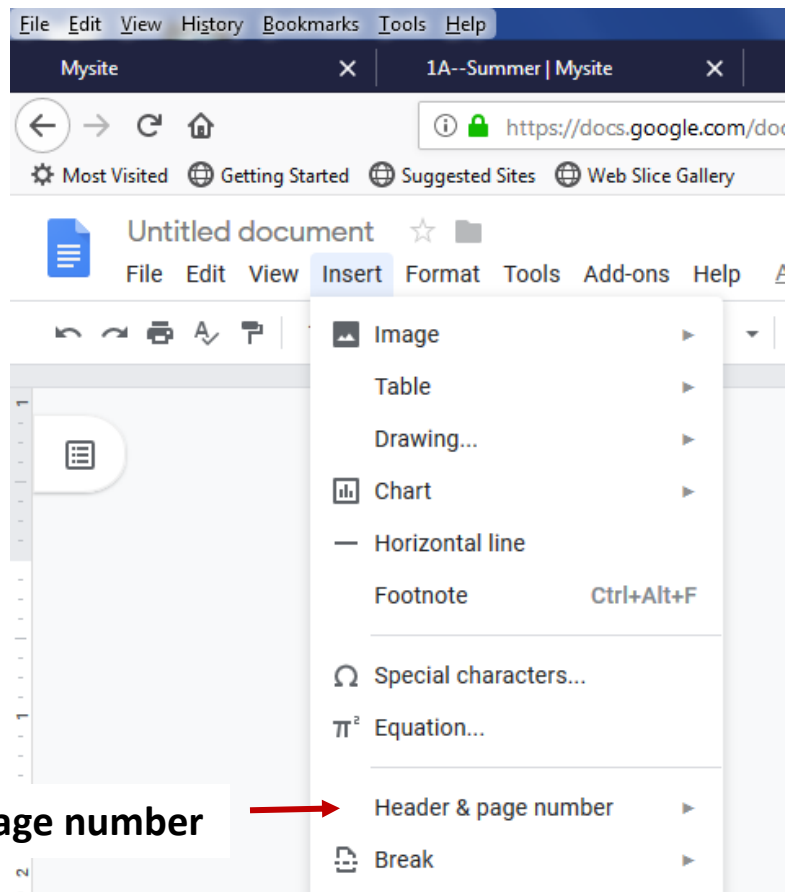

Click INSERT >> Header & page number

Choose “Page number,” and choose the upper-left option:

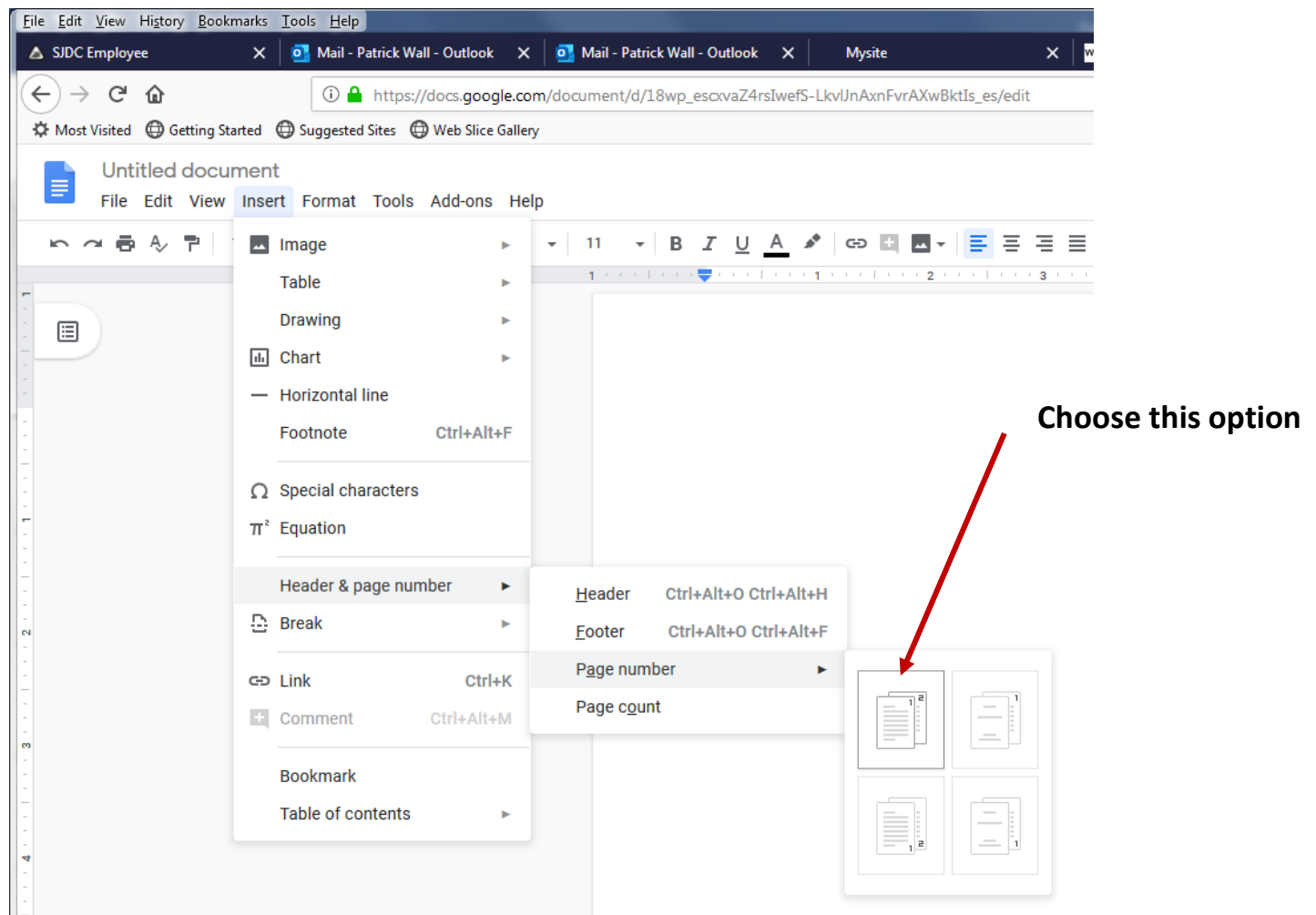

However, you don't want any numbering on the first page. So do this:

- Scroll to the first page of your essay. You will see the option

☐ Different first page

- Check the box:

☒ Different first page

- Hit the Esc (escape) button in the upper-left of your keyboard.

That's it! Your MLA pagination should now begin on page 2.